

Kamlock coupling with safety locking device

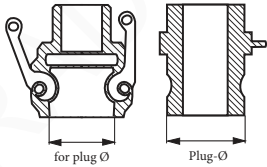

Kamlock coupling with safety locking device

MIL-C-27487

Function: A safety catch integrated in the hand levers locks the coupling fully automatically when it is coupled. The coupling can only be opened by manually unlocking the safety lever (2 1/2" and 6" with unlocking pin). All quick-release plugs (standardized according to MIL-C-27487) can be used as plugs.

Materials: Body: stainless steel 1.4408, seal: NBR, handle, ring and chain: stainless steel
 Temperature range: -10 °C to max. + 80 °C

Can only be opened by manual unlocking!

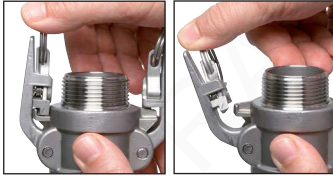

Advantages: Coupling is automatically secured when coupled

- Locking pins cannot be lost
- Full passage
- Low pressure loss
- Also suitable for solids as there are no internal valves
- Dimensions standardized worldwide according to MIL-C-27487

Kamlock coupling sockets with safety lock and external thread

Typ B

Thread	DN	for Plug Ø	PN
R 1"	25 (1")	36,7	16 bar
R 1 1/4"	32 (1 1/4")	45,5	16 bar
R 1 1/2"	40 (1 1/2")	53,4	16 bar
R 2"	50 (2")	63,0	16 bar
R 2 1/2"	60 (2 1/2")	75,8	16 bar
R 3"	75 (3")	91,5	14 bar
R 4"	90 (4")	119,5	7 bar
R 6"	140 (6")	175,9	7 bar

Kamlock coupling sockets with safety lock and internal thread

Typ D

Thread	DN	for Plug Ø	PN
Rp 1"	25 (1")	36,7	16 bar
Rp 1 1/4"	32 (1 1/4")	45,5	16 bar
Rp 1 1/2"	40 (1 1/2")	53,4	16 bar
Rp 2"	50 (2")	63,0	16 bar
Rp 2 1/2"	60 (2 1/2")	75,8	16 bar
Rp 3"	75 (3")	91,5	14 bar
Rp 4"	90 (4")	119,5	7 bar
Rp 6"	140 (6")	175,9	7 bar

Kamlock coupling sockets with safety lock and hose nozzle

Typ C

Hose Ø inside	DN	for Plug Ø	PN
25	25 (1")	36,7	16 bar
32	32 (1 1/4")	45,5	16 bar
38	40 (1 1/2")	53,4	16 bar
50	50 (2")	63,0	16 bar
63	60 (2 1/2")	75,8	16 bar
75	75 (3")	91,5	14 bar
100	90 (4")	119,5	7 bar
150	140 (6")	175,9	7 bar

Sealing caps with safety lock for quick release plugs

Typ DC

Size	DN	for Plug Ø	PN
1"	25 (1")	36,7	16 bar
1 1/4"	32 (1 1/4")	45,5	16 bar
1 1/2"	40 (1 1/2")	53,4	16 bar
2"	50 (2")	63,0	16 bar
2 1/2"	60 (2 1/2")	75,8	16 bar
3"	75 (3")	91,5	14 bar
4"	90 (4")	119,5	7 bar
6"	140 (6")	175,9	7 bar